

Release Note CP 1.0.8

New Features

1. Set Default Payroll Type for eClaims

System is now added with selection of payroll type for eClaims at company profile. User may select the eClaims to be posted to claim processor, first half payroll process or month end payroll process.

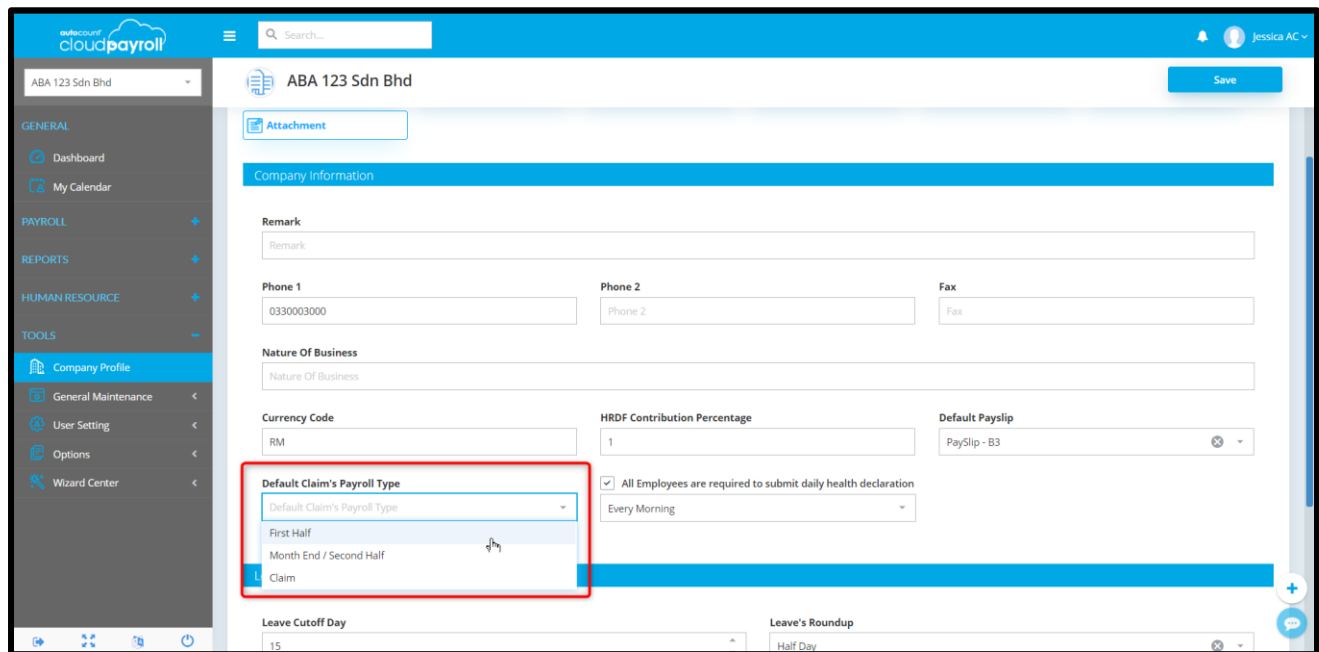

Kindly go to Tools > Company Profile > Company Information, Default Claim's Payroll Type.

2. New report filter

Added new filter for Project and Inactive Employees in Payroll Report.

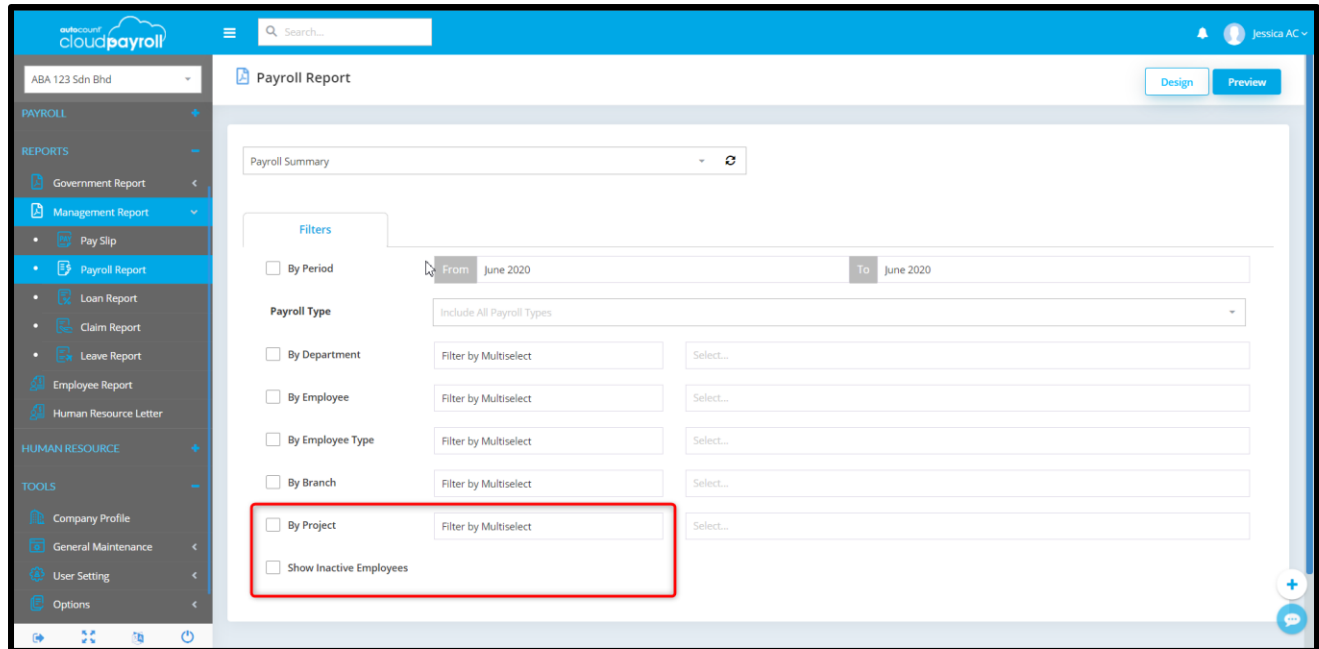

3. Filtered employee that had no run payroll process

System will list down those employees that had not been processed their payroll so HR can select the unprocessed employees to do payroll process again within the same period.

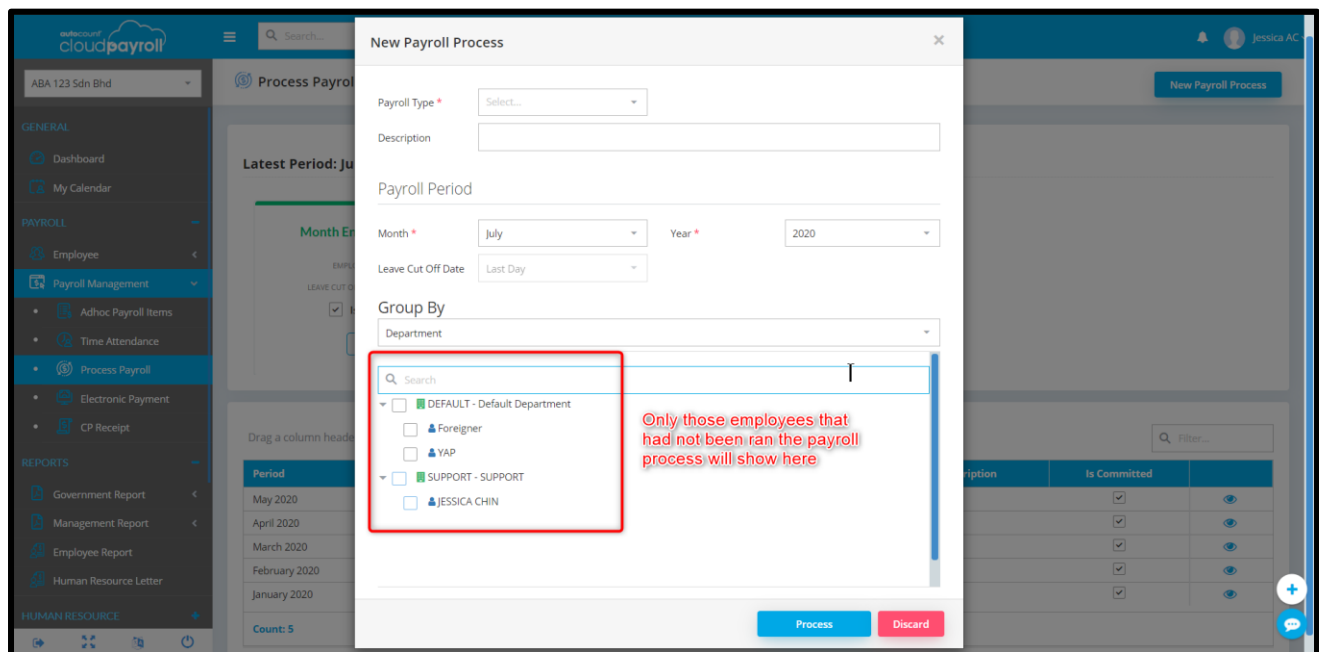

4. Allow user to edit and save note for Paid and Unpaid Leave

User is now able to edit and save the note for Paid and Unpaid Leave at payroll process.

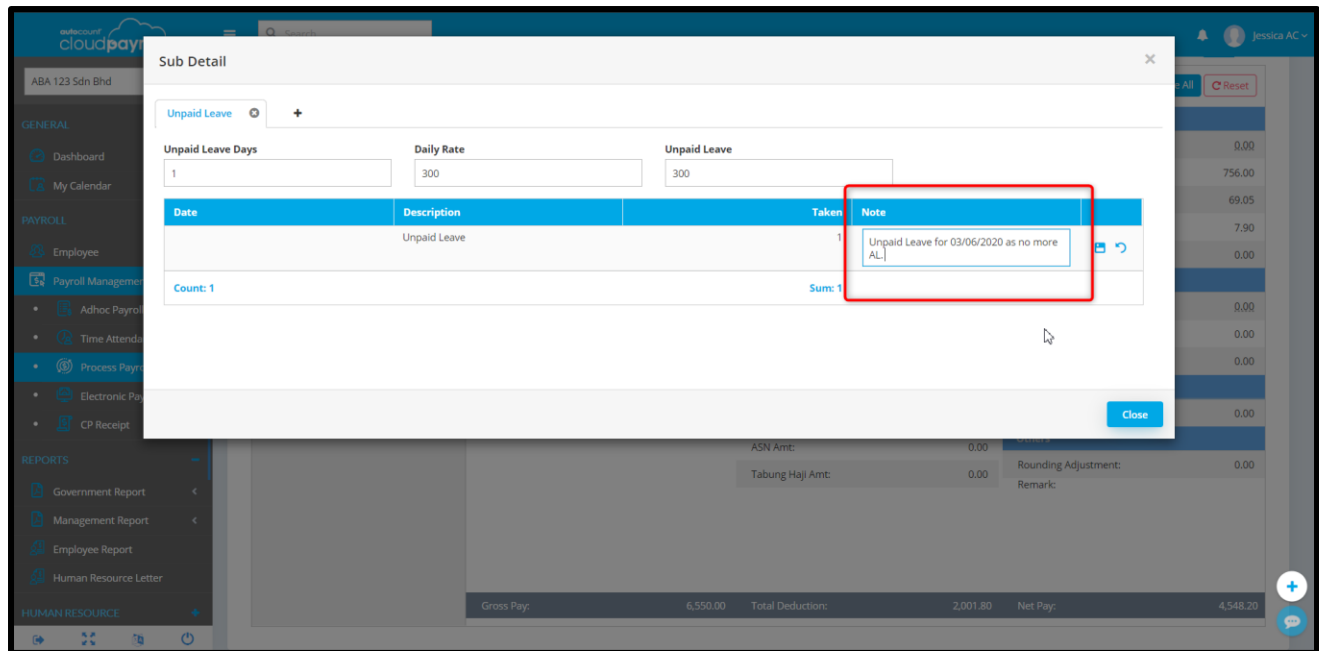

5. Monthly batch download

With the new feature of batch download, user can now download the reports they want with one click after commit the payroll process. The selection of the reports for batch download can be set at Company Profile.

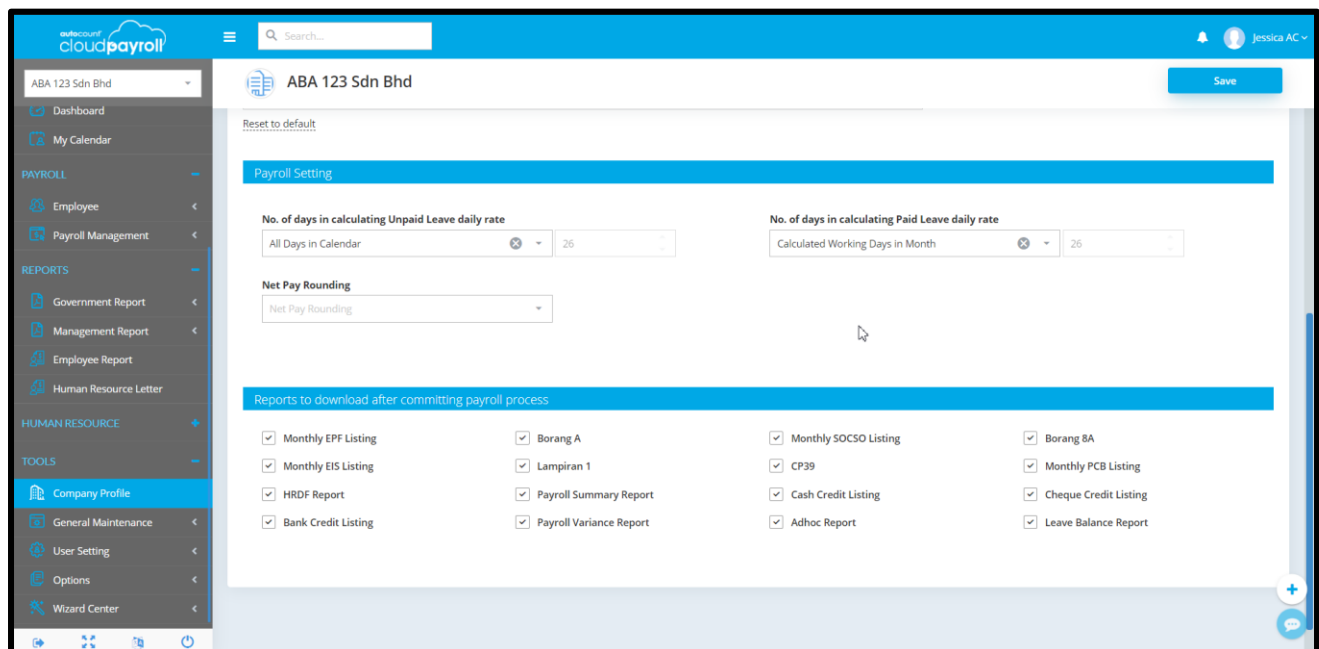

Kindly go to Tools > Company Profile > Contribution/Payout Setting, Reports to download after committing payroll process.

ABA 123 Sdn Bhd

Month End / Second Half @ May 2020

Summary

NUMBER OF EMPLOYEES: 2

TOTAL NET PAY: 5,284.50

LEAVE CUT OFF DATE: 2020-05-31

TOTAL PCB: 0.00

TOTAL EPF: 1,508.00

TOTAL SOCSO: 139.50

TOTAL EIS: 13.00

TOTAL HRDF: 62.80

Uncommit All Send notification

Batch Download

Summary Files

Employee	Job Title	Department	Salary	Gross Pay	Total Deduction	Net Pay
Foreigner		DEFAULT	3,000.00	3,000.00	344.75	2,655.25
JESSICA CHIN		SUPPORT	4,800.00	5,050.00	2,420.75	2,629.25
Count: 2				8,050.00	2,765.50	5,284.50

Kindly go to Payroll > Payroll Management > Process Payroll.

6. Support 5 decimal point for unpaid leave

System is now support 5 decimal places for Unpaid Leave days in adhoc payroll items and payroll process for calculation.

7. New design for create new subscription

New design screen for create new subscription. Now to be more user friendly to guide new user step by step on create a new subscription with all the info showed to let the user more understand on what is going on and notice on the charges part also.

SUBSCRIPTION

Pay As You Go

Subscription Name *

Subscription Name

Dealer Code (if any) Promotion Code (if any)

Dealer Code (if any) Promotion Code (if any)

Package

Basic

To learn more visit [Plans & Features](#)

Add-On

E-Leave E-Claim

COMPANY INFORMATION

Company Name *

Company Name

Registration Number *

Registration Number

Country *

Country

Payroll Year *

Payroll Year

Go Back Next

Summary Shown

Plan Summary

Subscription Type

Pay As You Go

Subscription Name

Subscription Name

Package Type

Basic

COMPANY

EMPLOYEES

Free 3 employees

Free of charge for 3 processed employees per month

8. New access right to view basic rate

New access right is added for HR to assign authorized personnel to view the basic rate.

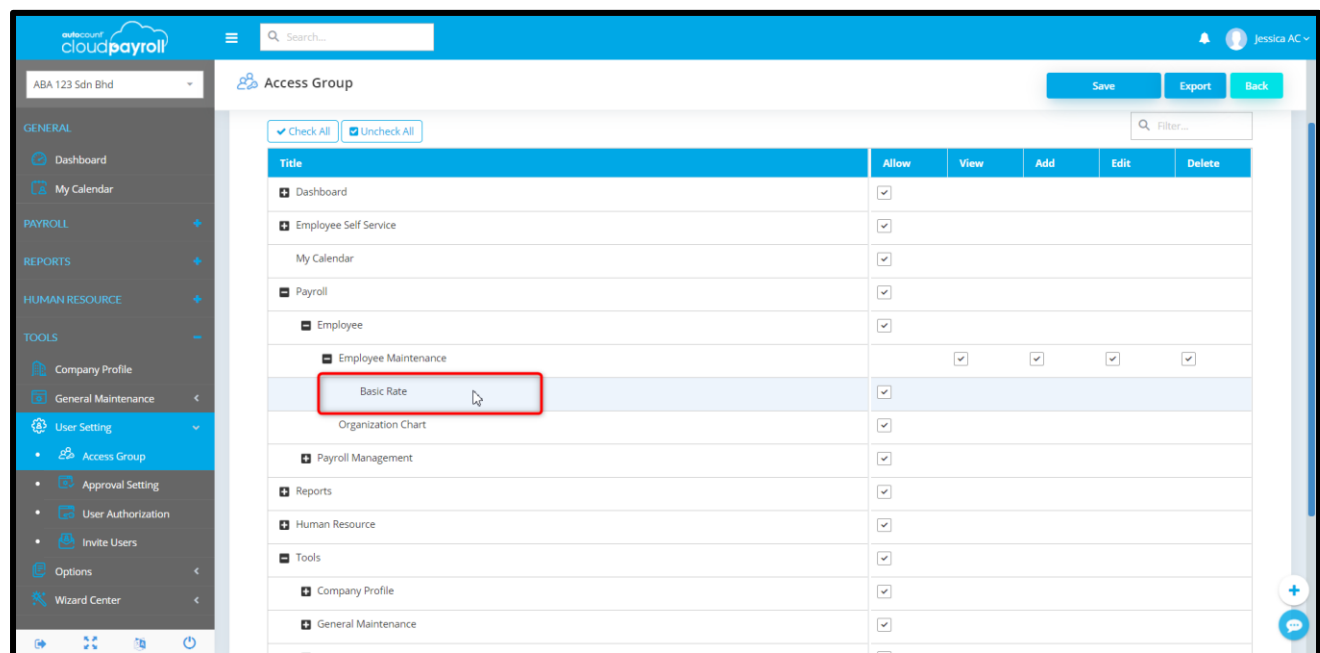

Kindly go to Tools > User Setting > Access Group, under Payroll > Employee > Employee Maintenance, Basic Rate.

9. Allow multiple payment method

Enhanced on payment method where allow customer to switch between self-care and credit card anytime.

10. Alliance bank file arrange by name

Electronic Bank Payment File for Alliance Bank is now order by name.

11. Payroll process rounding

Display rounded amount at payroll process.

12. Privacy on Leave Module

Now only approver and payroll user are able to view on the leave reason of the employees.

13. New RHB intrabank file

New electronic payment file for RHB intrabank.

14. New datasource in Payslip

Added new data source in Payslip B6 format for Adhoc Payroll Items.

15. Show last commit period in license portal

Dealers now able to view their client last commit period in the license portal.

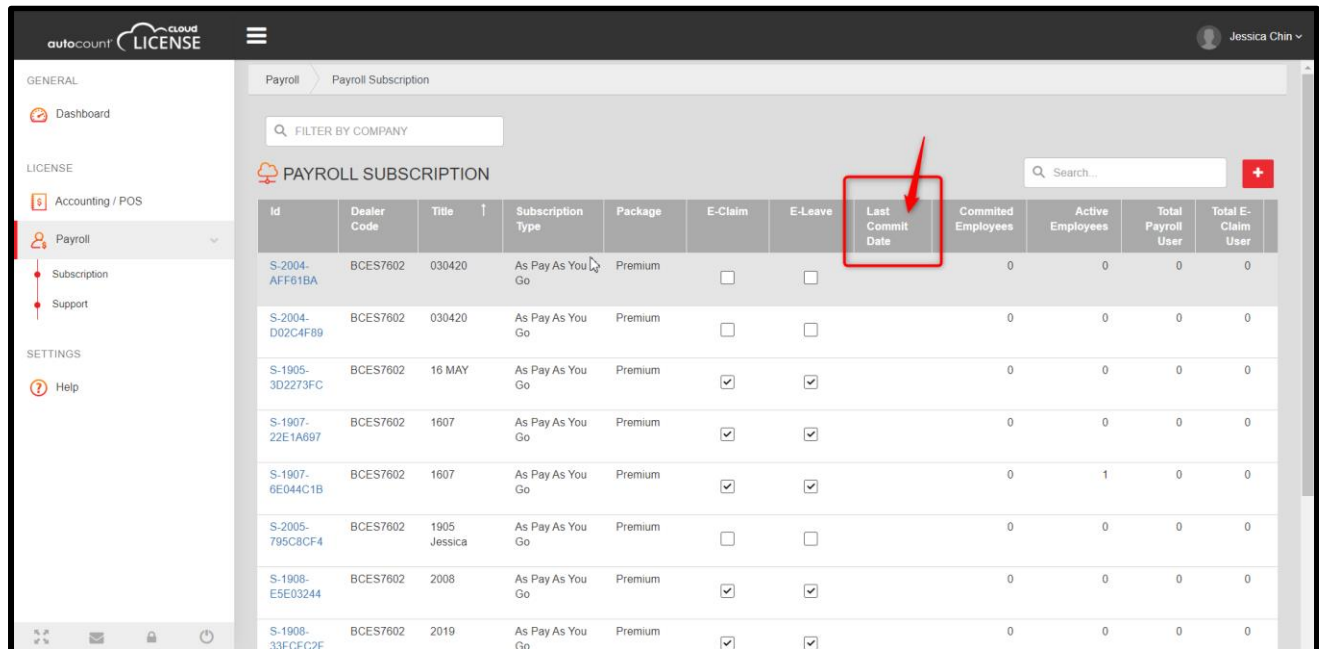

Id	Dealer Code	Title	Subscription Type	Package	E-Claim	E-Leave	Last Commit Date	Committed Employees	Active Employees	Total Payroll User	Total E-Claim User
S-2004-AFF61BA	BCES7602	030420	As Pay As You Go	Premium	<input type="checkbox"/>	<input type="checkbox"/>		0	0	0	0
S-2004-D02C4F89	BCES7602	030420	As Pay As You Go	Premium	<input type="checkbox"/>	<input type="checkbox"/>		0	0	0	0
S-1905-3D2273FC	BCES7602	16 MAY	As Pay As You Go	Premium	<input checked="" type="checkbox"/>	<input checked="" type="checkbox"/>		0	0	0	0
S-1907-22E1A697	BCES7602	1607	As Pay As You Go	Premium	<input checked="" type="checkbox"/>	<input checked="" type="checkbox"/>		0	0	0	0
S-1907-6E044C1B	BCES7602	1607	As Pay As You Go	Premium	<input checked="" type="checkbox"/>	<input checked="" type="checkbox"/>		0	1	0	0
S-2005-795C8CF4	BCES7602	1905 Jessica	As Pay As You Go	Premium	<input type="checkbox"/>	<input type="checkbox"/>		0	0	0	0
S-1908-E5E03244	BCES7602	2008	As Pay As You Go	Premium	<input checked="" type="checkbox"/>	<input checked="" type="checkbox"/>		0	0	0	0
S-1908-33FCEC2E	BCES7602	2019	As Pay As You Go	Premium	<input checked="" type="checkbox"/>	<input checked="" type="checkbox"/>		0	0	0	0

Enhancements

1. Enhancement on Report Header

Standardize on all report header. The period format for report header is changed to MM/YYYY.

2. Enhanced on the column chooser

Added create date and last modified date column for user to choose on almost all the maintenance screen in the system.

3. Enhanced on invoice notification email

Added period information in the invoice notification email.

4. Enhanced on eClaim Approver View

Approver now can see the total amount of the claim submission during approve.

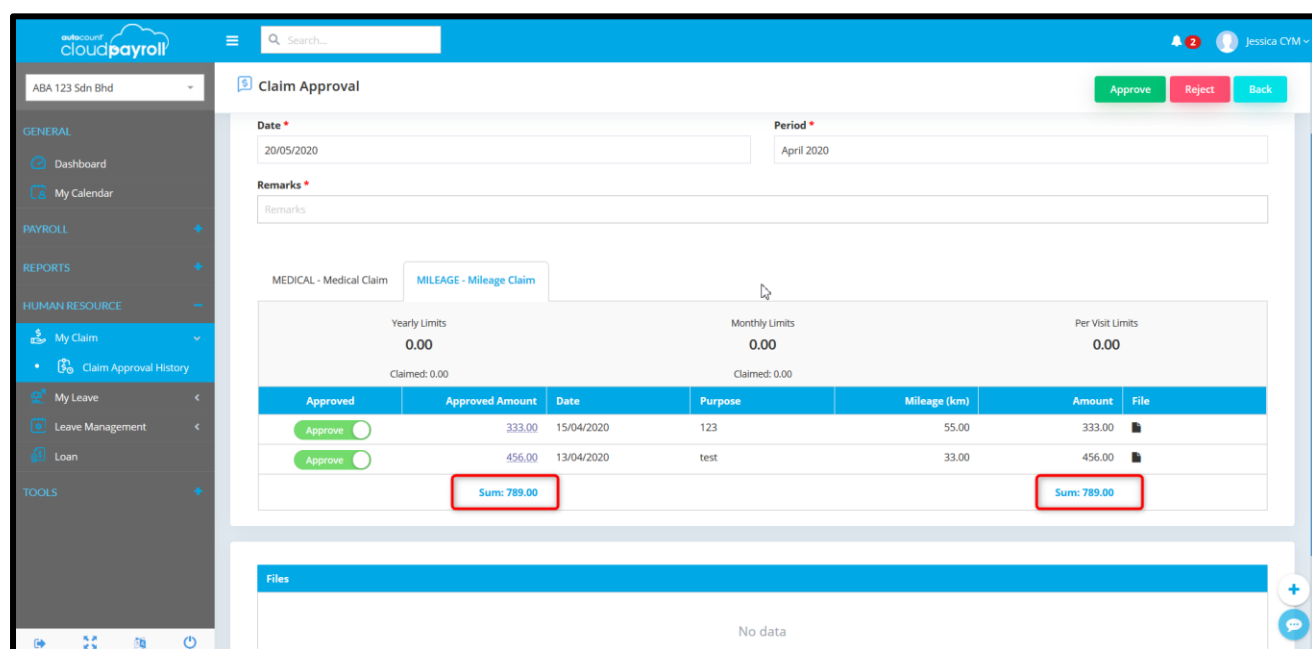

Approved	Approved Amount	Date	Purpose	Mileage (km)	Amount	File
<input type="radio"/>	333.00	15/04/2020	123	55.00	333.00	
<input type="radio"/>	456.00	13/04/2020	test	33.00	456.00	
				Sum: 789.00	Sum: 789.00	

5. Enhanced on Payslip

User now can add the leave taken details on Payslip.

6. Enhanced on Calendar Export

Bugs Fixed

1. Fixed report design unable to select DataSource.
2. Fixed error prompt when there is no calendar.
3. Fixed include non taxable allowance in LHDN calculator's current month's additional remuneration.
4. Fixed foreign worker need to contribute EIS when payment Arear is ticked to pay SOCSO and EIS.
5. Fixed reject unauthorised access to report function.
6. Fixed EPF electronic bank payment file for CIMB
7. Fixed SOCSO electronic bank payment file for RHB
8. Fixed data source error for Allowance Report.
9. Fixed EIS displayed empty value at B2 A5 Payslip format.
10. Fixed time attendance, OT worked days doesn't support 5 decimal place.

Prepared by Jessica

Last Modified 20th June 2020